



ELIPSE INTEGRA® HALF-FACE MASK + HESPA™ P100 DUST Filters

TDS
Technical
Data Sheet



APF 10
Assigned Protection Factor



Standards

NIOSH Approval number P100 TC-84A-8119
Elipse P100 respirator has met the requirements of 42CFR84 (Code of Federal Regulations)
Certified to ANSI Z87+

Efficiency

P100 >99,97% for 0.3 μ particulate

Weight

Mask + Filter: net (S/M) 7.23 oz; (M/L) 7.51 oz
gross (S/M) 11.18 oz; (M/L) 12.24 oz
Filter: net 0.67 oz each; both net 1.34 oz, gross 2.15 oz

Shelf Live

5 years (mask & filters) See storage conditions on Instructions for Use.
Filters are re-usable and changeable.

Material

- Mask:** Medical grade TPE Conforms to ISO 10993-10: 2010 for irritations. Mask body latex and silicone free, odor free. Valve Body in Nylon, Inhalation/Exhalation diaphragm in Silicone. 4 point adjustable elasticated head and neck strap with comfort pad in TPE.
- Filters:** Mechanical type multi-layer HESPA Synthetic media with TPE flexible overmolded / encapsulated.
- Goggle:** Polycarbonate with flow coating overmolded into soft TPE, permanently attached to the mask body by stainless steel clips.

Production

United Kingdom. 100% of filters NaCl Tested

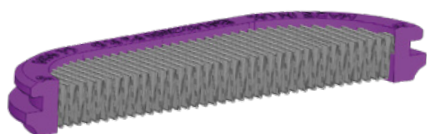

Encapsulation (patented technology)
645 mm; length of actual media in each filter

Applications - dust, mist and fumes

Grinding

Metal Fumes, Ozone and Dust



Manufacturing

Glass Fibers, Composite Fibers, Lead Fumes



Construction

Silica Dust, Abestos, Concrete Dust, Stone Dust, Aggregate Dust, Wood Dust, Cement Dust, Mold



Food

Poultry, Powders (Dairy), Spices, Grain Dust



Mining

Coal Dust, Silica Dust



Pharmaceutical

Powders, Viruses



GVS Filtration, Inc
2150 Industrial Drive
Findlay, OH 45840 - e-mail respirators@gvs.com
www.gvs.com

MADE IN UK ISSUE date 23/01/23
ISSUE n. 4